

# UNIVERSAL REMOTE INSTRUCTIONS

The Genuine. The Original.



NOT FOR USE WITH ANY GARAGE DOOR OPENER MANUFACTURED PRIOR TO 1993.  
SAFETY BEAMS (PHOTOCELLS) MUST BE IN PLACE AND OPERATIONAL.

## WARNING



### MOVING DOOR CAN CAUSE SERIOUS INJURY OR DEATH.

- **DO NOT** install transmitter unless the door operator's **safety device** works as required by the door operator's manual.
- Wall Console must be mounted in sight of door, at least 5 feet above floor and clear of moving door parts.
- **Keep people clear** of opening while door is moving.
- **DO NOT** allow children to play with the transmitter or door operator.
- **DO NOT** use transmitter or door operator. If **safety reverse** does not work properly:
- **Close door then disconnect opener** using the manual release handle.
- **DO NOT** use transmitter or door operator.
- Refer to Door and Door Opener Owner's Manuals before attempting any repairs.

### THINGS TO KNOW BEFORE STARTING:

- During programming, the garage door opener may operate. Ensure that the garage door opening is clear of personnel or any obstructions.
- Do not to press the LEARN button for longer than the noted 2-3 seconds as it could cause your existing, operational remotes and keypads to no longer work.

Below are the brands and specifications that this remote is compatible with and the available methods that can be used to program them. Review Chart A for compatibility and method, then proceed to STEP 1.

### Chart A

AVAILABLE PROGRAM METHOD		QUICK START METHOD	LEARN METHOD
Brand Name	Garage Door Opener or Gate Receiver Specification Notes	Pre-set Button Number on Remote	Number of Button Presses
Genie®	315/390 MHz, InTellicode® I, 1995-current	1	1
Overhead Door®	315/390 MHz, CodeDodger® I, 1995-current	1	1
Chamberlain® LiftMaster® CraftsMan®	Purple Learn Button, Security +®, 2006-2014, 315 MHz	2	2
	Orange/Red Learn Button, Security +®, 1996-2005, 390 MHz	3	3
	Yellow Learn Button, Security +2.0®, 2011-current, 390 MHz	4	4
	Green Learn Button, Billion Code®, 1993-1995, 390 MHz		5
Genie®	315/390 MHz, InTellicode® II, 2010-2011		6
Overhead Door®	315/390 MHz, CodeDodger® II, 2010-2011		6
Sommer®	310 MHz, Rolling Code		7
Linear®	318 MHz, Mega Code®		8
Wayne Dalton®	372.5 MHz, Rolling Code, 1999-current		9
Ryobi®	372.5 MHz, Rolling Code		10
Guardian®	303 MHz, Fixed Learn Code		11
Xtreme® brand	303 MHz, Fixed Learn Code		11
Marantec®	315 MHz, Fixed Learn Code		12
Chamberlain®	390 MHz, 9 Switch/3 Position Dip Switch	- TEACH & PAIR - Must have existing operational remote.	
FAAC®	433.92 MHz, Rolling Code		
Genie®	390 MHz, 9 & 12 Switch/2 Position Dip Switch, 1993-1995	For these dip switch instructions, visit <a href="http://www.overheaddoor.com">www.overheaddoor.com</a> *	
Overhead Door®	390 MHz, 9 Switch/3 Position Dip Switch, 1993-1995		

\*For instructions on these Genie or Overhead Door® specifications, visit [www.overheaddoor.com/Documents/912DIPSWITCHES.pdf](http://www.overheaddoor.com/Documents/912DIPSWITCHES.pdf)

Overhead Door and Ribbon Logo are registered trademarks of The Overhead Door Corporation. All other listed names and trademarks are the property of their respective owners.

**NOTE: During programming, the garage door opener will operate. Ensure that the garage door opening is clear of personnel or any obstructions.**

## STEP 1 - FIND SPECIFICATIONS & LEARN BUTTON

1. Locate the brand and opener/receiver specifications for your device by consulting the label on the opener/receiver, the instruction manual, the current remote controls for the opener, or the original manufacturer of the opener/receiver.
2. Find the LEARN/PROG button on your device - shape, color or name of this button could vary by brand. For garage door openers, be sure to check under the light covers. For commercial or gate openers, this button may be on the circuit board of the opener. In some cases, this button could also be on an external receiver that is mounted on or nearby the product. Consult the devices manual if needed.

### EXAMPLES:

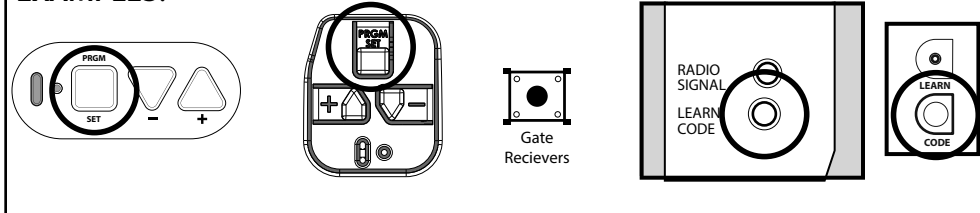

\*For Marantec® openers, reference operator manual to program remotes to the operator head.

## STEP 2 - ACTIVATE REMOTE/BUTTON LAYOUT & LED

LED - The LED will light with each button press and will also light in response to button presses during different programming modes.

Activation Tab: Pull tab to activate the remote.

FIG. 1

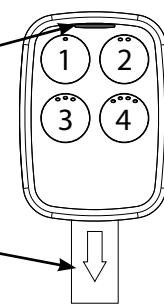

## STEP 3 - CHOOSE A PROGRAMMING OPTION

Review Chart A to find your specifications and available programming options. You can use any combination of options available for your opener/specification combination to achieve your desired button setup. Each button can be programmed individually to operate up to 4 different brands of garage door openers and gate receivers.

### OPTION 1: QUICK START METHOD

Reference FIG 1 to use any of these four manufacturer pre-sets to quickly program a button.

- Button 1:** Genie InTellicode 1 or Overhead Door CodeDodger I
- Button 2:** Chamberlain® with a PURPLE LEARN Button
- Button 3:** Chamberlain® with an ORANGE/RED LEARN Button
- Button 4:** Chamberlain® with a YELLOW LEARN Button\* - Move directly to Chamberlain® Yellow Learn Button instructions shown at right.

#### If using Button 1, 2 or 3:

1. On the garage door opener, press the LEARN button for 2-3 seconds and then release.
  2. On the universal remote, press and release the pre-set button that corresponds with your opener once every 2 seconds until the garage door opener operates. Programming is complete.
- TIP:** Allow the LED light on the universal transmitter to stop flashing before your next button press.

### OPTION 2: LEARN METHOD

In this method, your universal remote will learn which specification you want it to work with.

1. Find and remember the required number of button presses in the LEARN METHOD column next to your brands/specification in Chart A.
  2. On the universal remote, press and hold down button #2. (Reference FIG. 1)
  3. While still holding down button #2, press button #4 on the universal remote four times.
  4. Release both buttons - the BLUE LED on the remote will begin flashing.
  5. On the universal remote, press the button of your choice the required number of times from Step 1. You will have 15 seconds to complete this task.
  6. Wait the remainder of the 15 seconds - the BLUE LED will give a long blink and then go out. \*If using Chamberlain with Yellow LEARN button, please move directly to the Chamberlain® YELLOW LEARN button instructions shown right. If using ANY OTHER brand/specification, please continue below.
  7. On the garage door opener, press the LEARN button for 2-3 seconds and then release.
  8. On the universal remote, press and release the button you just programmed once every 2 seconds until the garage door opener operates. Programming is complete.
- TIP:** Allow the LED light on the universal transmitter to stop flashing before your next button press.

### OPTION 3: TEACH & PAIR

You must have an existing operational remote to use this method. The universal remote can learn from an existing operational remote transmission and then be paired to the available brands/specification in Chart A.

1. On the universal remote, press and hold down button #1.
  2. While still holding down button #1, press button #2 on the universal remote four times.
  3. Release both buttons - the WHITE LED on the remote will begin slowly flashing.
  4. Place the existing, operational remote and the universal remote within 4" of each other.
  5. Hold down the operational button from the original remote. Do not release until the new universal remote blinks change from slow WHITE blinks to rapid BLUE blinks. You will have 20 seconds to complete your entry.
- TIP:** If the universal remote does not recognize the transmission, try different distances between 0"-4" away from the side of the universal remote closest to button numbers 1 and 3.
6. Once the universal remote BLUE LED is blinking rapidly, press the button of choice on the universal remote one time, slowly and deliberately. The BLUE LED will turn solid and then go out. \*If using Chamberlain with Yellow LEARN button, please move directly to the Chamberlain® YELLOW LEARN button instructions below. If using ANY OTHER brand/specification, please continue below.
  7. On the garage door opener, press the LEARN button for 2-3 seconds and then release.
  8. On the universal remote, press and release the button you just programmed once every 2 seconds until the garage door opener operates. This could take several presses. Programming is complete.
- TIP:** Allow the LED light on the universal transmitter to stop flashing before your next button press.

### \* CHAMBERLAIN® YELLOW LEARN BUTTON INSTRUCTIONS:

For use with Chamberlain® technology with a YELLOW LEARN button:

1. On the garage door opener, press the LEARN button for 2-3 seconds and then release.
  2. On the universal remote, press and release the pre-set button OR the button you just programmed once every 2 seconds until the garage door opener operates. Let it run until it stops.
- TIP:** Allow the LED light on the universal transmitter to stop flashing before your next button press.
3. Repeat steps 1 and 2 above.
  4. Test the button - programming is complete.

### PROGRAMMING ASSISTANCE:

If the opener does not activate after the steps shown, repeat steps or call 1-800-929-3667 for programming assistance. You may also scan this QR code for additional information and links.



### Changing the Battery:

Remove small phillips head backing screw. Pry case open with small coin or screwdriver. Replace battery with **CR2032 coin cell**.

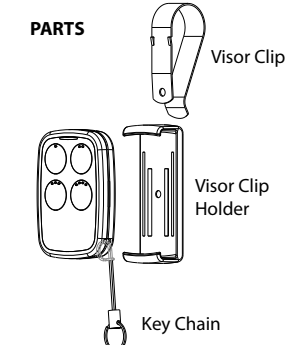
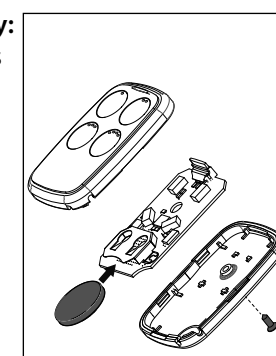

For Patent Information: [www.overheaddoor.com/patent](http://www.overheaddoor.com/patent),  
©2019 The Overhead Door Corporation

**FCC Part 15.21 Statement:**  
Changes or modifications not expressly approved by the party responsible for compliance could void the user's authority to operate the equipment.

**FCC / IC Statement:**  
This device complies with FCC Part 15 and Industry Canada licence-exempt RSS standard(s). Operation is subject to the following two conditions: (1) this device may not cause harmful interference, and (2) this device must accept any interference received, including interference that may cause undesired operation of the device.

# CONVERSION INSTRUCTIONS FOR GENIE® & OVERHEAD DOOR® FIXED CODE DIP SWITCHES

*What do fixed code dip switches look like and how do I convert them to button presses on my new universal remote?*

If you have a group of 9 switches with 3 positions per switch (**TRINARY**):

- Switch in the UP position = Press button 1
- Switch in the MIDDLE position = Press button 2
- Switch in the DOWN position = Press button 4

In this example, the button presses would be:

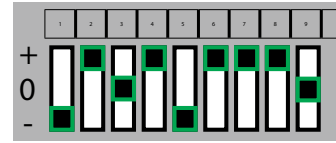

4 1 2 1 4 1 1 1 2

If you have a group of 9-12 switches with 2 positions per switch (**BINARY**):

- Switch in the UP position = Press button 1
- Switch in the DOWN position = Press button 4

In this example, the button presses would be:

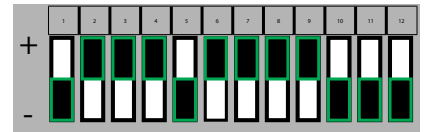

4 1 1 1 4 1 1 1 1 4 4 4

**STEP 1: Each shaded box below represents a DIP switch position.** In these boxes, write in the number 1, 2 or 4 as it corresponds to the UP, MIDDLE or DOWN switch position you see on the remote, opener head or receiver.

Convert the code:

--	--	--	--	--	--	--	--	--	--	--

- Switch in the UP position = write a "1"
- Switch in the MIDDLE position = write a "2"
- Switch in the DOWN position = write a "4"

Each box should contain a 1, 2, or 4. Each box should correspond to the position of the switch on your remote opener head or receiver. If you have less than 12 switches, only fill in what you have.

\*You will need to reference this section in STEP 3.4 below.

**STEP 2: Determine which specification/combination you have from the CHART B below:**

### CHART B

BRAND NAME	NUMBER OF SWITCHES/POSSIBLE POSITIONS	NUMBER OF TIMES TO PRESS THE BUTTON OF YOUR CHOICE
Genie®	12 switches with 2 possible positions (UP, DOWN)	1
	9 switches with 2 possible positions (UP, DOWN)	2
Overhead Door®	9 switches with 3 possible positions (UP, MIDDLE, DOWN)	3

Circle the number of button presses in **Chart B** above or write it below. This will tell your remote what brands/spec's you have.

This box should say 1, 2 or 3.

\*You will need to reference this section in STEP 3.9 below.

**STEP 3: Programming the Universal Remote:**

#### ENTER LEARN MODE:

1. On the universal remote, press and hold down button #1.
2. While still holding down button #1, press button #4 on the universal remote four times.
3. Release both buttons - The WHITE LED on the remote will quickly flash 4 times.

#### ENTER DIP SWITCHES:

4. \*On the universal remote, enter in order the numbers 1, 2 or 4 as you have written in STEP 1. The LED lights with each button press..
5. After the last DIP switch position entry, simply wait for the BLUE LED to quickly flash 4 times and go out.

#### ENTER BUTTON SELECTION MODE:

6. On the universal remote, press and hold down button #2.
7. While still holding down button #2, press button #3 on the universal remote four times.
8. Release both buttons - the BLUE LED on the remote will begin flashing.
9. Press the button of your choice on the universal remote the required number of times indicated from Chart B in STEP 2 above\*. You will have 10 seconds to complete your entry.
10. After your press(es), simply wait the remainder of the 10 seconds - the BLUE LED will give a long blink and then go out.
11. Test the remote.

**PROGRAMMING ASSISTANCE:** If the opener does not activate after the steps shown, repeat steps or call 1-800-929-3667 for programming assistance.

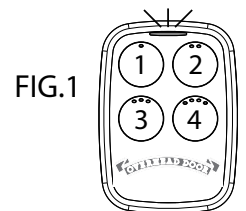

FIG.1